

Connecting your Adjustable Base to the OKIN Remote App

Step 1. Download the App

Open Google Play or App Store and download the free OKIN Remote app



Step 2. Unplug your Base

Unplug your base from the power socket in the wall
Wait 30 seconds and plug it back in

Step 3. Enable the Bluetooth

Press and hold the top two buttons of your adjustable base remote
Wait until you hear the power box under the base make a sound
This sound represents that the base is ready to connect with the app



Step 4. Connect to the App

Open the OKIN Remote App on your phone
Select OKIN-Receiver
Pop up will appear that states 'Bluetooth Pairing Request'
Select Pair
App is now connected and ready

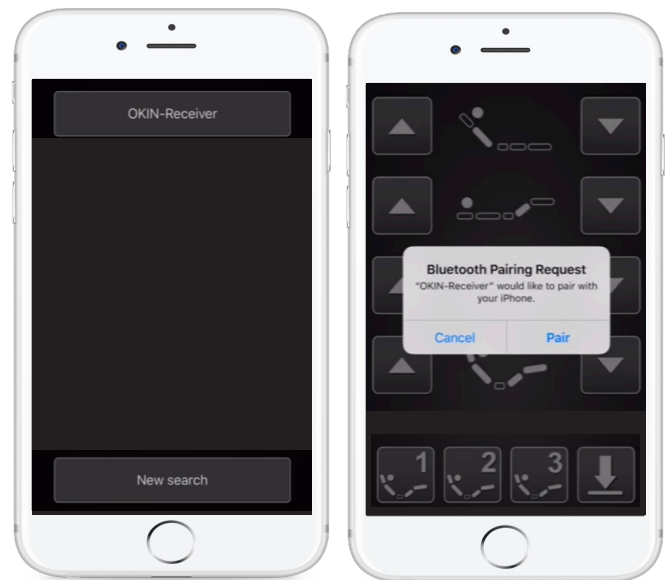

Contact Details

If you are having difficulty connecting your adjustable base, please contact Customer Care on:

- E: customer care@ahbeard.com
- P: 1300 654 000